

FAG

**625**

## Deep groove ball bearing

Schaeffler ID:  
0383909060000Deep groove ball bearing 62, single row,  
steel sheet metal cage

## Technical information

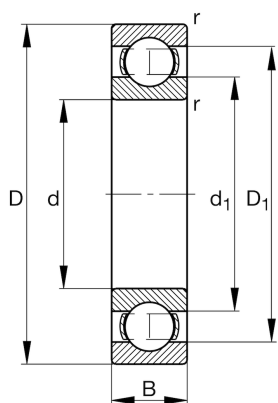
**Main Dimensions & Performance Data**

d	5 mm	Bore diameter
D	16 mm	Outside diameter
B	5 mm	Width
$C_r$	1,735 N	Basic dynamic load rating, radial
$C_{0r}$	671 N	Basic static load rating, radial
$C_{ur}$	23 N	Fatigue load limit, radial
$n_G$	63,000 1/min	Limiting speed
$n_{gr}$	36,000 1/min	Reference speed
	0.004 kg	Weight

**Dimensions**

$r_{min}$	0.3 mm	Minimum chamfer dimension
$D_1$	12.5 mm	Shoulder diameter outer ring
$d_1$	8.55 mm	Shoulder diameter inner ring

**Mounting dimensions**

$d_{a min}$	7.4 mm	Minimum diameter shaft shoulder
$D_{a max}$	13.6 mm	Maximum diameter of housing shoulder
$r_{a max}$	0.3 mm	Maximum fillet radius

**Calculation factors**

$f_0$	12.4	Calculation factor
-------	------	--------------------

**Temperature range**

$T_{min}$	-30 °C	Operating temperature min.
$T_{max}$	120 °C	Operating temperature max.